

Hardware Fittings — Ductile Iron

Socket Clevis

Socket clevises are used primarily for connecting associated hardware to ball and socket type insulators.

Material: Body – galvanized ductile iron
Clevis Pin – galvanized steel
Cotter Pin – stainless steel

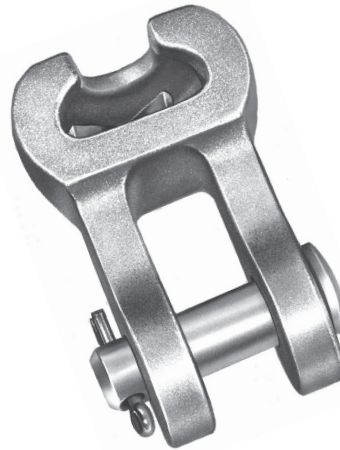

DUCTILE IRON

SC

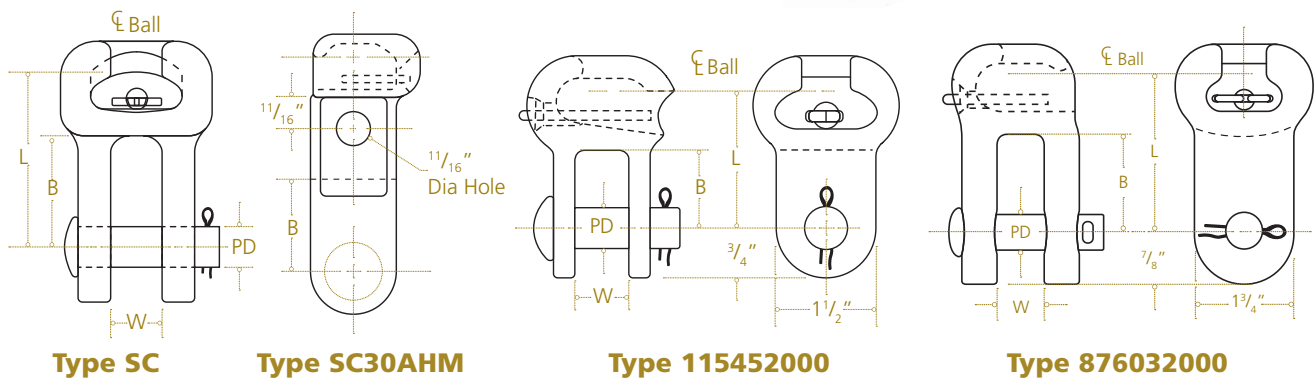

Type SC

Type SC30AHM

Type 115452000

Type 876032000

Product Data

Catalog Number	Ultimate Strength lb (kN)	Dimensions Inches (mm)				Approx Wt Each lb (kg)
		W	L	B	PD	
876032000	30,000 (133)	13/16 (20.6)	25/8 (66.7)	15/8 (41.3)	5/8 (15.9)	2.7 (1.22)
SC30	30,000 (133)	7/8 (22.2)	25/8 (66.7)	111/16 (42.9)	5/8 (15.9)	2.0 (.91)
SC30AHM	30,000 (133)	7/8 (22.2)	4 1/2 (114.3)	115/16 (49.2)	5/8 (15.9)	3.5 (1.58)
SC301	30,000 (133)	1 1/8 (28.6)	37/8 (98.4)	27/8 (72)	5/8 (15.9)	3.0 (1.36)
115452000 ⁽¹⁾	18,000 (80)	13/16 (20.6)	2 1/8 (54)	13/16 (30.2)	5/8 (15.9)	1.35 (.61)
SC501 ⁽²⁾	50,000 (222)	1 1/8 (28.6)	3 3/32 (85.3)	2 1/16 (52.4)	7/8 (22.2)	4.6 (2.09)

NOTE: For use with class 52-3 and 52-5 insulators per ANSI Spec. C-29.2-71. Bolt and nut may be substituted for clevis pin by adding suffix "BNK" to catalog number.

(1) For use with class 52-3 insulators only per ANSI Spec. C-29.2-71.

(2) For use with class 52-8 and 52-11 insulators per ANSI Spec. C-29.2-71